

**NOVA** SWISS



**Up to 4500 BAR (65000 PSI)**  
**HIGH PRESSURE SAFETY VALVES**



# High-Pressure Safety Valves

Among a wide range of components Nova Swiss offers also safety valves to protect high-pressure circuits. Set pressures are available from 50 bar (730 psi) up to 4500 bar (65000 psi) for both gases and liquids.

The versatility of Nova Swiss safety valves can further accommodate a wide spread of temperatures and are available also for explosive environments.

Compatibility of all components in contact with circuit fluid, temperature and connections are checked and validated and possibly customized.

Exhaust port is pipeable for most of the available models, increasing the safety of high-pressure circuits.

Each valve supplied is set and certified based on customer specification and factory lead sealed.

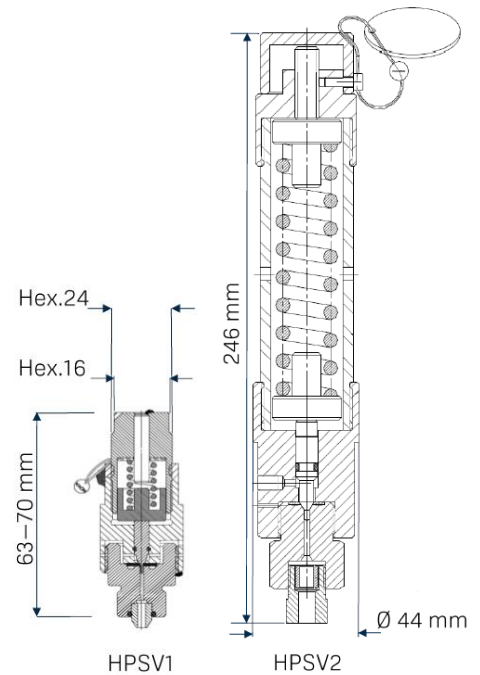

## Safety Valve Features:

- HPSV1 4E (1/4" metric) M16 x 1,5 male pressure connection
- HPSV2 4E (1/4" metric) M16 x 1,5 female pressure connection
- 1/4" NPT-F (4N) exhaust connection (HPSV2)
- Flow area 0,72mm<sup>2</sup> (HPSV2) / 0,75mm<sup>2</sup> (HPSV1)
- Flow rates, H<sub>2</sub>O, from 38 to 360 l/h
- Flow rates, air, from 4,8 to 424 Nm<sup>3</sup>/h
- Std. materials 1.4418, 1.4404, 1.4980, 2.4819
- Temperature range -40°C to +320°C (-4°F - 608°F)
- Compliant with PED 2014/68/EU
- ATEX compliant
- Full traceability of manufactured parts
- Unique serial number
- Lead sealed - CE marked

Nova Part No.	Material	Setting range bar (psi)	Temperature °C (°F)	Flow Area mm <sup>2</sup> (in <sup>2</sup> )	Flow rate H <sub>2</sub> O l/h (usg/h) **	Flow rate air Nm <sup>3</sup> /h (usg/h) **
HPSV1-16-M105	1.4418 (APX4)	50 - 1100 (725 - 15950)	-40 / +75 (-40 / 167)	0,75 (0,00116)	45 - 215 (11,9 - 56,8)	5,6 - 121,6 (1479 - 32123)
HPSV2-12-M103*	1.4404 (316L)	50 - 800 (725 - 11630)	-10 / +250 (14 / 482)	0,72 (0,00112)	38 - 150 (10 - 39,6)	4,8 - 75,5 (1268 - 19945)
HPSV2-36-M105	1.4418 (APX4)	50 - 2500 (725 - 36260)	-10 / +250 (14 / 482)	0,72 (0,00112)	38 - 270 (10 - 71,3)	4,8 - 235 (1268 - 62080)
HPSV2-36-M105-ET	1.4418 (APX4)	50 - 2500 (725 - 36260)	-20 / +320 (-4 / 608)	0,72 (0,00112)	38 - 270 (10 - 71,3)	4,8 - 235 (1268 - 62080)
HPSV2-22-M205	2.4819 (Hastelloy C276)	50 - 1500 (725 - 21760)	-10 / +250 (14 / 482)	0,72 (0,00112)	38 - 210 (10 - 55,5)	4,8 - 141 (1268 - 37248)
HPSV2-30-M207-ET*	1.4980 (Incoloy A286)	50 - 1900 (725 - 27560)	-20 / +320 (-4 / 608)	0,72 (0,00112)	38 - 235 (10 - 62,1)	4,8 - 179 (1268 - 47286)
HPSV2-65-M105	1.4418 (APX4)	2500 - 4500 (36260 - 65270)	+5 / +150 (41 / 302)	0,72 (0,00112)	270 - 360 (71,3 - 95,1)	235 - 424 (62080 - 112009)

\* Add suffix '-AT' for ATEX version

\*\* Flow rate at min./max. setting of the range, temperature +15°C, according to ISO 4126 Standard

## Pressure Connection Details HPSV2

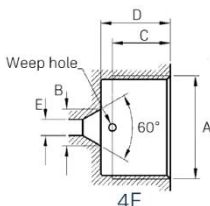

A	B	C	D	E
M16 x 1,5	5,0mm (0,2")	9,7mm (0,38")	11,5 (0,45")	2,4mm (0,09")

HPSV1 is free exhaust

HPSV2 exhaust connection 1/4" NPT-F (4N)

[novaswiss.com](http://novaswiss.com)

Nova Swiss France · 31 rue Denis Papin · 77240 Cesson (France) · +33 1 64 41 18 48 · [info@novaswiss.com](mailto:info@novaswiss.com)